



QMX3.P37 QMX3.P34 / P74 QMX3.P02 QMX3.P70 QMX3.P30

Desigo™ TRA

Wall-mounted sensors and room operator units for KNX PL-Link, KNX S-mode and KNX LTE-Mode







QMX3.P30
QMX3.P70
QMX3.P02
QMX3.P34
QMX3.P74
QMX3.P37

Communicative sensors, switches and room operator units with KNX (S-mode, LTE-Mode) or KNX PL-Link (for Desigo™ Total Room Automation)

Functions (depending on type):

- Energy efficiency function ("Green Leaf )
- Room temperature, CO₂, and humidity measurement
- Control of light, blinds, and scenes
- PID controller for room temperature or ventilation (KNX S-mode)
- LCD Display for room temperature, operating mode, etc.
- Label for light, blinds and scenes (exchangeable, created with Word template)
- Operation via 8 or 16 touchkeys
- Interface KNX (S-mode, LTE-Mode) and KNX PL-Link (for TRA, with plug & play functionality)
- Powered over KNX PL-Link / KNX bus
- LEDs to indicate the switch state or the position of the device in dark rooms

Type summary, ordering

	Product number	Stock number	Features						
			Temperature sensor	Sensor for humidity and CO ₂	Air quality indicator with LED	Segmented backlit display and touchkeys	"Green Leaf" LED	Configurable touchkeys with LED display	Window for labels
Sensors	 QMX3.P30	S55624-H103	X						
	 QMX3.P70	S55624-H104	X	X	X				
Room operator unit	 QMX3.P02	S55624-H107	X					X	X
	 QMX3.P34	S55624-H105	X			X	X		
	 QMX3.P74	S55624-H106	X	X		X	X		
	 QMX3.P37	S55624-H108	X			X	X	X	X

Use / compatibility

Use with KNX PL-Link The room automation station determines the functions of both LCD display and keys.

- **Measure and indicate** the room temperature, humidity and CO₂.
- **Operate** the room functions.
- **Indicate external information** (outdoor temp., outdoor humidity, state of a window switch).

Use with KNX S-mode

Measure and indicate

- the room temperature
- the relative humidity
- the CO₂ concentration

Indicate external information

- outdoor temperature
- outdoor humidity
- state of a window switch

Control (with a PID controller)

- of the room temperature

Control (threshold value switch)

- of the relative humidity
- of the CO₂ concentration

Switches

- switching and dimming of lights
- control of blinds
- selecting and saving of scenes

**Use with
KNX LTE-Mode**

LTE can only use the sensor information of the types QMX3.P30 and QMX3.P70.



Note!

Devices with CO₂ measurement are not suitable for safety applications such as gas or smoke alarm.

Mechanical design

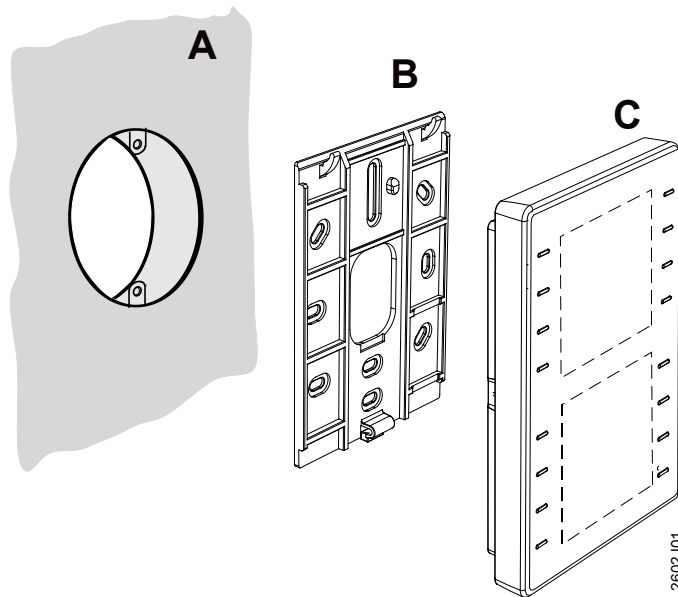

- The devices are designed for **wall-mounting (A)**. A conduit box is optional.
 - **Conduit box:** Keep in mind the dimensions of the conduit box!
 - **Cable conduits on the wall:** Keep a distance of 30 mm (from above) / 20 mm (from below) to the base plate **(B)**, so that the device **(C)** can be snapped onto the base plate.
- The **base plate (B)** has screw holes for all common flush-mount boxes.
The screw head height must not exceed 3 mm.
- The **device (C)** incorporates a KNX / PL-Link plug, and, depending on the type, sensor element, keys, LCD panel, window for the label.
The cable can be pushed into channels on the rear.
- A KNX plug is enclosed with the devices

Disposal



The devices are considered electronic devices for disposal in terms of the European Directive 2002/96/EC (WEEE) and may not be disposed of as domestic waste.

Dispose of the devices via the proper channels.

Observe all local and applicable laws.

KNX PL-Link

- The room operator units offer plug & play functionality.
- The room operator units receive their power from the connected room automation station via the KNX PL-Link interface.
- KNX PL-Link supports plug & play functionality for pre-configured devices out of the library
- For KNX PL-Link wiring (topology, allowed cables and cable length), see the Desigo installation guide, CM111043.
- Normally, electrical installers only install the base plate and the KNX PL-Link plug.
- Use the tear-off label with the barcode on the packaging / on the display and stick it on the floor plan to prepare commissioning for several room operator units per room automation station.
The same barcode label with unique identifier is available on the device.

KNX S-mode

Engineering and commissioning is done using the ETS tool
For detail information see Technical basics, P1602.

KNX LTE-Mode

Engineering and commissioning is done using the ACS tool.
For detail information see Technical basics, P1602.

Labels for switches (QMX3.P02, P37)

- The ABT provides a list of the devices, their function and their location
- Create the labels using a Word template (M1602.1)
- Print the labels on commercially available overhead transparency film
- Cut out the labels
- Insert or exchange the labels as described in the mounting instructions, M1602.

Mounting and installation

Location (sensors, room operator units)

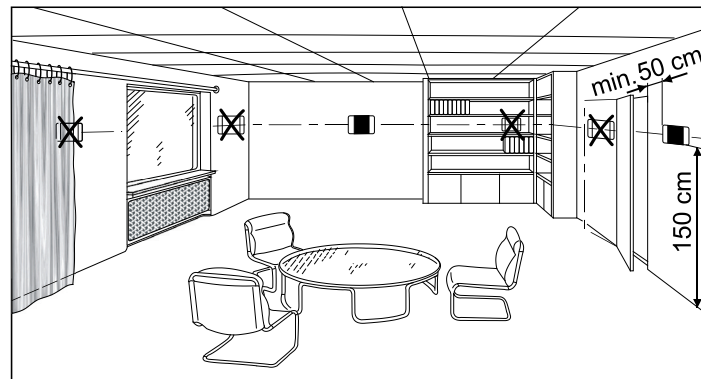

- The devices are suitable for wall mounting.
- Recommended height: 1.50 m above floor.
- Do not mount the devices in recesses, shelves, behind curtains or doors, or above or near heat sources.
- Avoid direct solar radiation and drafts.
- Seal the conduit box or the installation tube, as air currents can affect sensor readings.
- Adhere to allowed ambient conditions.

Mounting instructions

- Mounting instructions M1602 are enclosed with the devices.

Mounting over a conduit box:

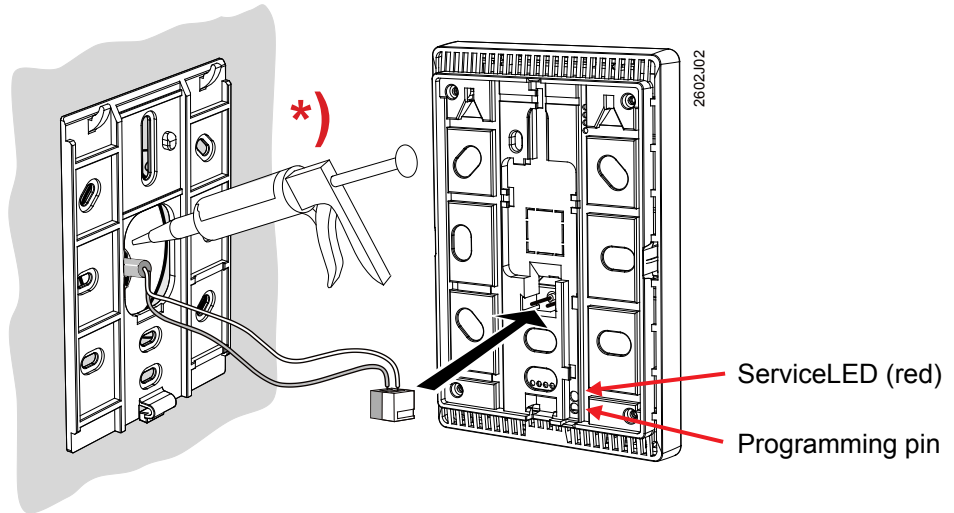

*) The installing tube must be sealed or cold or warm air may enter the device and cause faulty temperature readings by the internal sensor.

Wall mounting

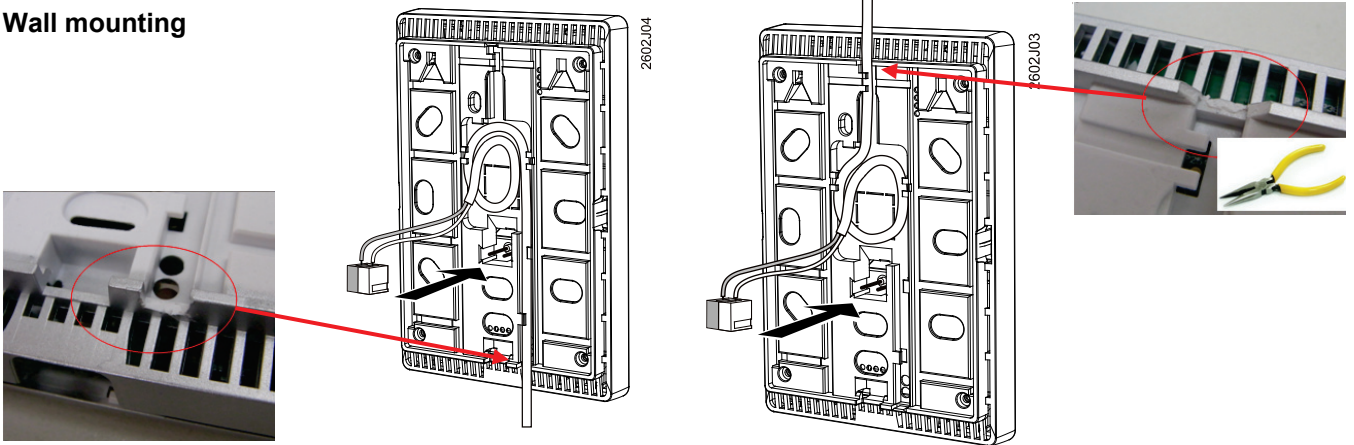

Remove the breakout on the housing before putting the cable into the gaining channel.

4-wire cables (daisy chain wiring)

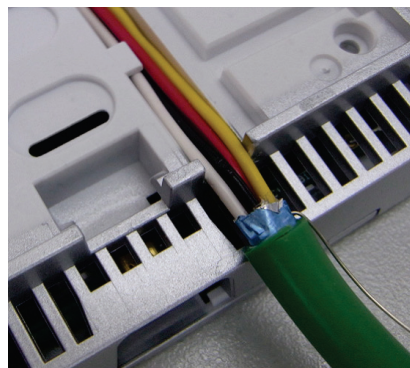

Remove the cable coating, as it will not fit in the gaining channel.

Cable ducts on the wall

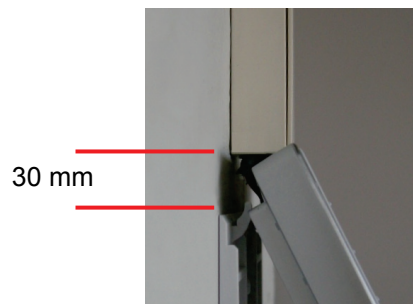

Keep a distance of 30 mm (from above) / 20 mm (from below) to the base plate, so that the device can be snapped onto the base plate.

Dismounting / service:

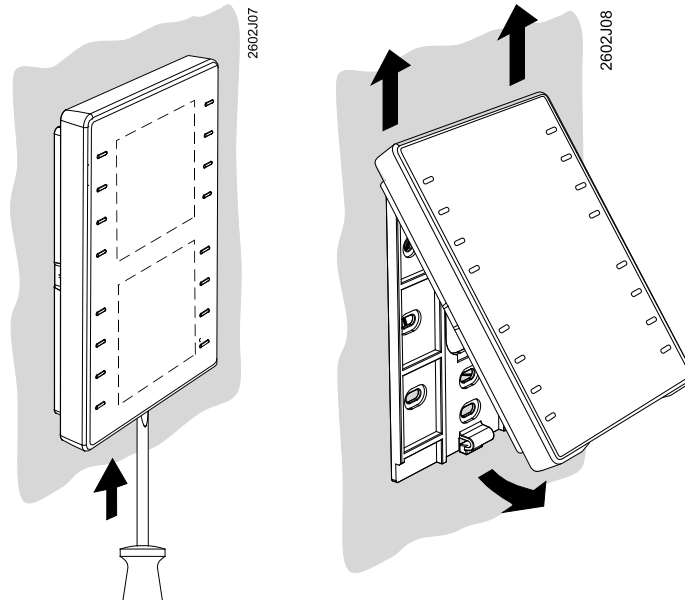

Labels for QMX3.P02, QMX3.P37

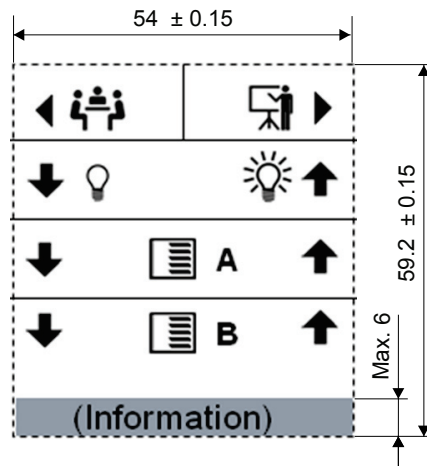

Sample icons are available in the label template M1602.1

Information. e.g. on room operator unit location or on room type (free text)

Insert label

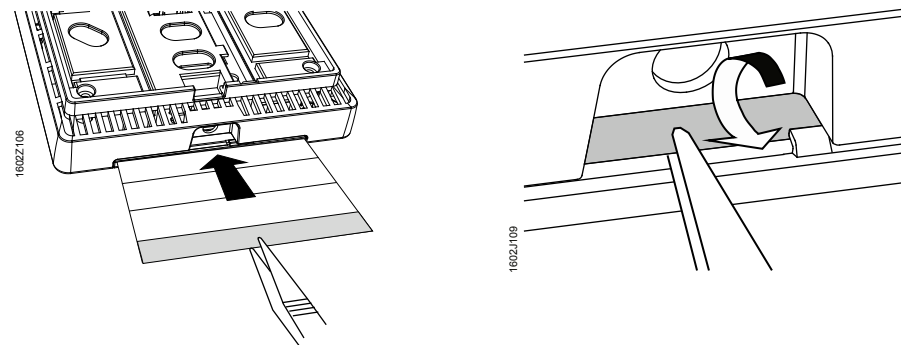

Remove label

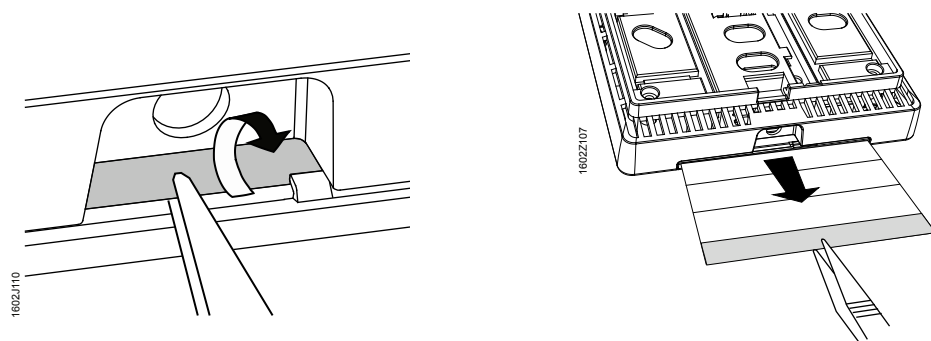

Installation

- For KNX PL-Link wiring (topology, allowed cables and cable length), see the Desigo TRA installation guide, CM111043.
- Use the correct cables for the KNX PL-Link bus
- Do not interchange the wires of the KNX PL-Link cable.
 - The red terminal is for KNX PL-Link +
 - The gray terminal is for KNX PL-Link –
- For KNX S-mode follow the KNX regulations
- Observe all local installation regulations.
- **The devices are not protected against accidental connection to AC 230 V.**



Caution!

Prerequisite for commissioning (KNX PL-Link)

The room automation station must be running and an application must be loaded.

Load application on the room automation station

The application is not loaded on the room operator unit, but the room automation station.
Download of the application is done using the SSA-DNT (Pack & Go) or the ABT. For this purpose (or for service), connect the ABT to the room automation station (USB or Ethernet).

Manual commissioning (KNX PL-Link)

All commissioning work is done via the room automation station, using the SSA-DNT or the ABT.

The ABT is never connected directly to a room operator unit.

When more than one QXM3.P... room operator unit is on the same trunk of the KNX PL-Link bus, manual commissioning is done as follows:

1. Connect the SSA-DNT or the ABT to the room automation station and activate the online commissioning function.
2. Load the web page "KNX PL-Link identification".
Activate the identification function.
The room automation station now waits for a signal from the room operator unit.
3. On the room operator unit, simultaneously press the upper left and bottom right button for at least 5 seconds (keys 1 and 8).
4. The "Engineering" page  is displayed.
5. Press "Prog. Mode" (Key 2).
The display changes from "DISA" to "EnAB".
The tool identifies the current room operator unit that is operated and assigns it.
6. After the device is commissioned, reset the device to programming mode to "disabled" by pressing key 2.

Addressing

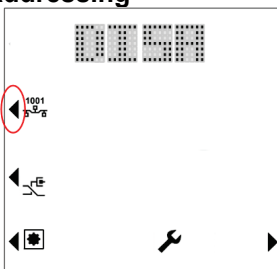

Note: Programming mode resets to "disabled" each time the device restarts.

Connection test

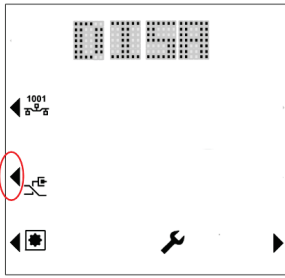

1. Press "Conn. Test" (key 3) to test the KNX PL-Link connection.

The display shows the result of the connection test:

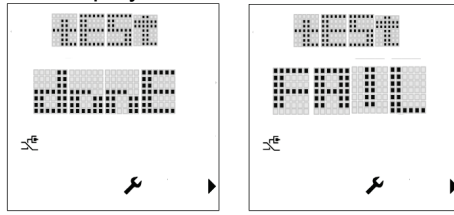

2. Press key 8 to return to the engineering page.

Reset to factory setting

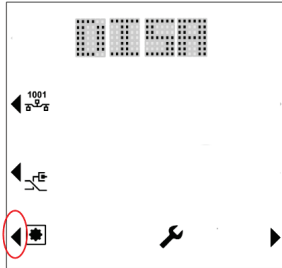

Press "Fact. Reset" (Key 4). The device is locked and reboots within 10 seconds. The room automation station deletes it from its device list. During this time, it is safe to remove the device from the network.

If the bus plug remains connected, the device acts like a newly inserted device requiring again automated or manual configuration.



Note! This operation resets all user preference data and configuration settings to factory default. This operation is irreversible.

Manual commissioning (KNX PL-Link, without display)

The devices are equipped with a programming pin and a red service LED on the back side (see page 4)

Addressing

1. Short press the programming pin (<0.5 s).
The device goes into programming mode; the service LED is continuously on.
The tool identifies the current room operator unit that is operated and assigns it.
2. After the device is commissioned, deactivate the programming mode by shortly pressing the programming pin (<0.5 s). The service LED goes off.

Note: Programming mode resets to "disabled" each time the device restarts.

Connection test

1. Medium press the programming pin (>2 s and <20 s) to test the KNX PL-Link connection. After releasing the programming pin, the test of the KNX PL-Link connection starts; the service LED flashes (1/4 s on, 7/4 s off).
After approx. 10 s, the test result is displayed:
 - If the test is positive, the LED goes on continuously.
 - If the test fails, it flashes (1 s on, 1 s off).
2. Short press the programming pin (<0.5 s) to stop displaying the result of the connection test. The service LED goes off.

Reset to factory setting

Long press the programming pin (>20 s). The device is locked and reboots within 10 seconds. The room automation station deletes it from its device list. During this time, it is safe to remove the device from the network.

Note: there is no LED activity during this operation.

If the bus plug remains connected, the device acts like a newly inserted device requiring again automated or manual configuration.







Note! This operation resets all user preference data and configuration settings to factory default. This operation is irreversible.

Commissioning (plug & play, KNX PL-Link)

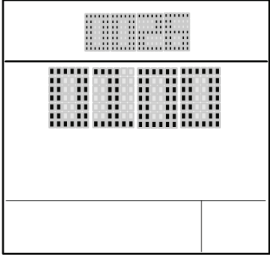
When **only one device** is connected to the KNX PL-Link bus, the room operator unit automatically establishes communications with the room automation station, from where the functions are downloaded to the room operator unit (plug & play).

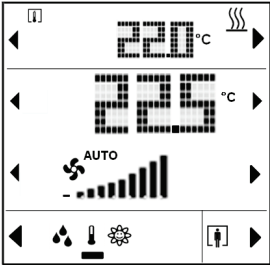
The following routine is executed:

Step	With display	Description
1		The Build number and the version number of the device are displayed.
2		The Individual Address (IA) is downloaded to the device via KNX PL-Link. This step is skipped if the device is already configured. Note: The configuration file can be downloaded any time; as a result, these characters are displayed every time the room automation station initializes download.
3a		After startup, the device goes to normal operation (example view; picture depends on application in room automation station).
3b		When configuration is faulty, "UCFG" is displayed, along with the temperature that is measured by the local temperature sensor. In this case, manual commissioning must be performed (see above).

Commissioning (KNX)

The devices are equipped with a programming pin and a red service LED for KNX commissioning (see page 4).

Addressing

1. Short press the programming pin (<0.5 s).
The device goes into programming mode; the service LED is continuously on.
The tool identifies the current room operator unit that is operated and assigns it.
2. After the device is commissioned, deactivate the programming mode by shortly pressing the programming pin (<0.5 s). The service LED goes off.

Note: Programming mode resets to “disabled” each time the device restarts.

Reset to factory setting

Long press the programming pin (>20 s). The device is locked and reboots within 10 seconds. The room automation station deletes it from its device list. During this time, it is safe to remove the device from the network.

If the bus plug remains connected, the device acts like a newly inserted device requiring again automated or manual configuration.



Note!

This operation resets all user preference data and configuration settings to factory default.

This operation is irreversible.



Note!

Operation and display of the room operator unit depend on the control program running on the room automation station.

Numbering of the keys

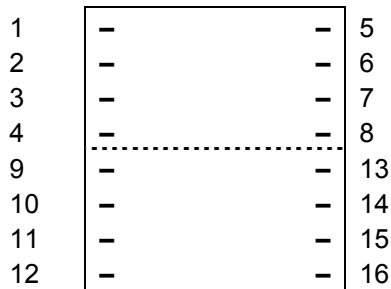

Keys 1...8 for room operating units

Keys 9...16 for switches

LED display (upper right corner)

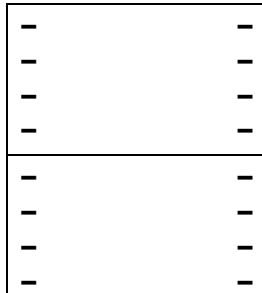

- / Green Leaf (green, red: Indicates the Energy efficiency (room operator units))
- green, orange, red: Indicates the air quality (multi sensor QMX3.P70)

Switches / keys

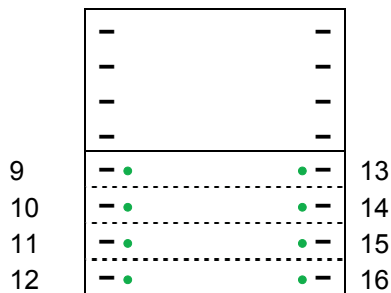

- Each line can be a pair of keys or two separate keys (Light *), blinds **), scenes ***)
- Each key is equipped with an LED (green)

*) Light

- The activity of the LEDs depends on the application running on the room automation station

**) Blinds

- Always dual key operation (Up / Down)
- The activity of the LEDs depends on the application running on the room automation station

***) Scenes

- Selecting a predefined scene (short press, <0.5.s). LED is on for 3 s.
- Saving a changed scene (long press > 5s). LED flashes during 3 s. When it goes off, the user can release the key.

Display layout of room operator units

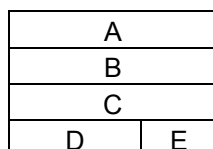

- A Display (temp., AQ, r.h.)
- B Setpoint adjustment (temperature) ****)
- C Operation (fan, operating mode)
- D Navigation
- E Presence / Comfort prolongation (display, operation)

****) Setpoint adjustment

- Absolute value (23.5 °C) or relative value (+2 °C)

Function of the display elements and keys

Key	Key
1	5
2	6
3	7
4	8



	<ul style="list-style-type: none"> An arrow indicates that an element can be operated
	<ul style="list-style-type: none"> Temperature display in °C or °F / humidity in % r.H. / air quality in text, symbol, or ppm of CO₂
	<ul style="list-style-type: none"> Toggling (key 1) between indoor and outdoor measurement (temperature, humidity, CO₂)
	<ul style="list-style-type: none"> Indication that a window is open (connected window switch is active)
	<ul style="list-style-type: none"> Display of the plant state (Heating or Cooling / inactive) Note: No manual switchover! Key 5 is used for Green Leaf
	<ul style="list-style-type: none"> Green Leaf function: Pressing key 5 activates the RoomOptiControl function.
	<ul style="list-style-type: none"> Display of the relative or absolute setpoint for temperature Adjusting the setpoint using keys 2 and 6
	<ul style="list-style-type: none"> Display of the present fan speed (when automatic) Adjusting the fan speed using key 3 (or keys 3 and 7 if operation of room operating mode is disabled)
	<ul style="list-style-type: none"> Display of the room operating mode (when automatic) Adjusting the room operating mode using key 7
	<ul style="list-style-type: none"> Navigation: toggle the display / setpoint setting between temperature / humidity / CO₂, using key 4. The black bar points to the displayed information.
	<ul style="list-style-type: none"> Operation of the occupancy state (presence switch, Comfort prolongation) Activate the Comfort prolongation using key 8 (only available if enabled)
	<ul style="list-style-type: none"> Engineering functions (press keys 1 and 8 simultaneously during 5 s) <ul style="list-style-type: none"> – Programming mode (key 2), same function as programming pin – Connection test (Key 3) – Reset device to factory settings (key 4) Note: This operation is irreversible!
	<ul style="list-style-type: none"> Indicates that the room operator unit is locked by the system. <ul style="list-style-type: none"> – Operation is disabled – The display in line 1 shows the temperature from bus

Maintenance



Note!





The device can be cleaned with off-the shelf, solvent-free cleaning agents. Do not use mechanical aids (rough sponge or similar materials) – only a soft, damp cloth.

Technical data

Supply voltage	Operating voltage range	KNX / PL-Link DC 21...30 V
	The device receives its power from the connected room automation station via the KNX / PL-Link interface	
Power consumption (from room automation station)	QMX3.P02	Max 7.5mA at DC 24 V
	QMX3.P30	Max 7.5mA at DC 24 V
	QMX3.P34	Max 7.5mA at DC 24 V
	QMX3.P37	Max 10mA at DC 24 V
	QMX3.P70	Max 15mA at DC 24 V
	QMX3.P74	Max 15mA at DC 24 V
Operating data	Temperature sensor (all types)	
	Measuring element	NTC resistance sensor
	Measuring range	0...50 °C
	Measuring accuracy (5 ... 30 °C)	±0.8 K
	Measuring accuracy (25 °C)	±0.5 K
	Relative Humidity Sensor (r.h.) (QMX3.P74;QMX3.P70)	
	Measuring range	10%...95% r.h.
	Accuracy (20%...80%)	±4% at 25°C
	Accuracy (0%...20%, 80%...95%)	±6% at 25°C
	CO ₂ Sensor (QMX3.P74;QMX3.P70) *)	
	Measuring range	400..10000 ppm
	Measuring accuracy at 23 °C and 1013 hPa	≤ ±(30 ppm +5% of measured value) for measured value 400...2000 ppm; degraded accuracy for measured value >2000 ppm.
	Temperature dependency	±2 ppm / °C typical
Pressure dependency	0.14% of measured value / hPa	
Long-term drift	≤±20 ppm per year	
Service life	15 years	

*) Notes on CO₂ sensor

- **Function:** The sensor determines the CO₂ concentration via infrared absorption measurement (NDIR). The sensor is maintenance free in normal environments, thanks to the built-in self-correcting ABC (Automatic Baseline Correction) algorithm. This algorithm keeps track of the sensor's lowest reading within 8 days and corrects for any drift detected. The sensor also contains self-diagnostics to assure proper operation during lifetime.
- **Use:** Normal environments, such as offices, class rooms, hotel rooms, or other non-permanently occupied areas, typically reach at least once a week the CO₂ concentration of fresh air of 400 ppm. However, exposure to a lowest CO₂ concentration other than fresh air, or incorrect altitude parameter setting, might result in reduced accuracy and incorrect operation.
- Rough handling during **transport, storage or mounting** might adversely affect accuracy during the first days of operation.
- The specified **accuracy** is reached after 25 days of continuous operation.

Display	Type Information displayed depends on the application in the room automation station.	Segment LCD – Room temperature, humidity, CO ₂ – Setpoint adjustment – Control mode – Manually selected fan speed – Control sequence – Scenes (LED next to the button) – etc.
Ports/interfaces	Type of port between room automation station and room operator unit Baud rate Standard KNX plug Cable type Single cable length (from room automation station to room operator unit) <u>Cables must comply with KNX specifications, see TRA Installation manual, CM111043</u>	KNX / PL-Link 9.6 kbps Wire diameter 0.8 mm, max. 1.0 mm (solid conductors only) Solid conductors 2-core, twisted pair <1000 m
Housing protection	Protection standard as per EN 60529	IP 30
Protection class	Insulation protection class	III
Ambient conditions	IEC 721 Environmental conditions Temperature Humidity Mechanical conditions	Normal operation Transport Class 3K5 Class 2K3 0...50 °C – 25...70 °C < 85 % rh < 95 % rh Class 3M2 Class 2M2
Standards and directives	Product safety Automatic electronic controls for household and similar use General requirements for Home and Building Electronic Systems (HBES) and Building Automation and Control Systems (BACS) - Part 3: Electrical safety requirements Electromagnetic compatibility Immunity (industrial) Emissions (domestic)  compliance Meets requirements of EMC directive RoHS compliance  compliance  compliance CSA compliance  C-Tick conformity (EMC) The product environmental declaration CM2E1602 contains data on environmentally compatible product design and assessments (RoHS compliance, materials composition, packaging, environmental benefit, disposal)	EN 60730-1 EN 50491-3 HBES (for KNX) EN 6100-6-2 EN 50491-5-2 EN 6100-6-3 EN 50491-5-3 2004/108/EU 2011/65/EU (RoHS Directive) UL916 Part 15 of the FCC rules C22.2 No 205 – Signal equipment C22.2 No 0 – General Requirements AS/NZS 61000-6-3 ISO 14001 (environment) ISO 9001 (quality)

Color Front housing Titanium white similar to RAL9010

Weight [g]	QMX3. P02	P30	P34	P37	P70	P74
Operator unit	91	84	122	124	97	132
Base plate	20	20	20	20	20	20
Packaging	64	64	64	64	64	64
Total	175	168	206	208	181	216

Connection terminals

KNX / PL-Link plug

- + Red KNX PL-Link (positive)
- Gray KNX PL-Link (negative)



Note!

Wires are NOT interchangeable!

The device is protected against faulty wiring, but communications does not work on interchanged wires.

Wiring diagrams

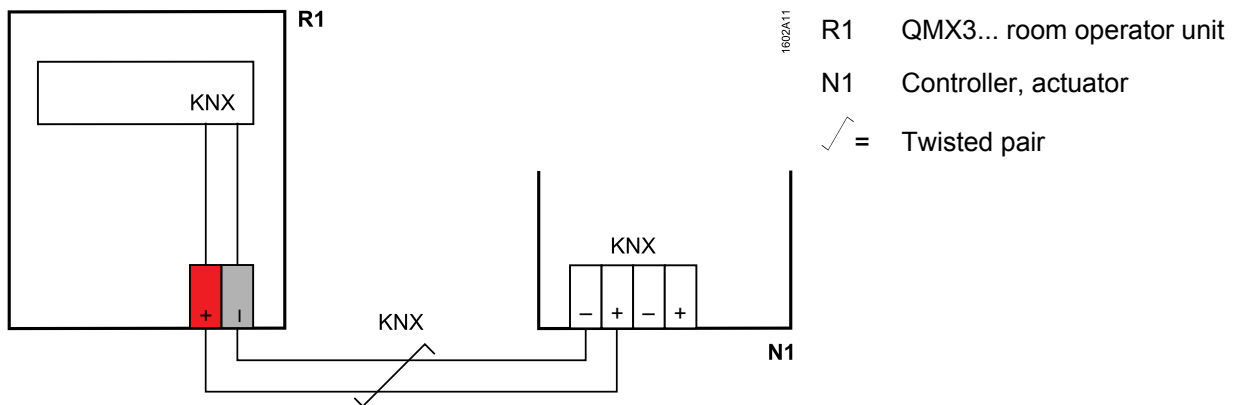

Dimensions room operator unit

